

- SH. ROSE ©
- NATURAL ST
- ±600 HIGH B
- GUM POLE S
- NATURAL ST

Outside

- ±2200 AFFL
- ±2200 HIGH AFFL
- LONG GUM POLE
- ±2200 HIGH AFFL
- PLINTH WALL
- ±2200 AFFL

Outside Bath

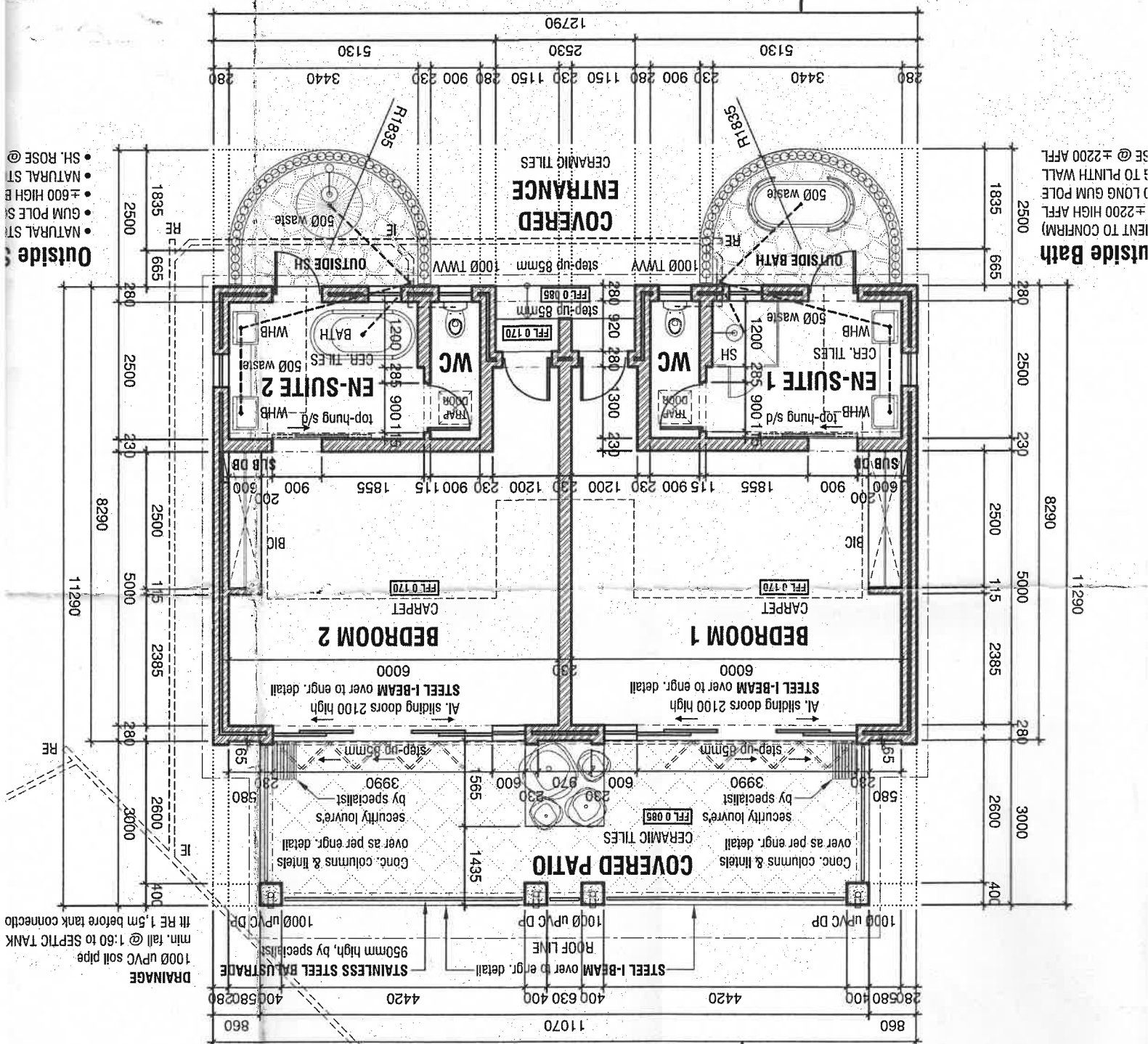

SEPTIC TANK
2500 LITRE CAPACITY
HEIGHT: 1.710m
DIAMETER: 1.550m

